

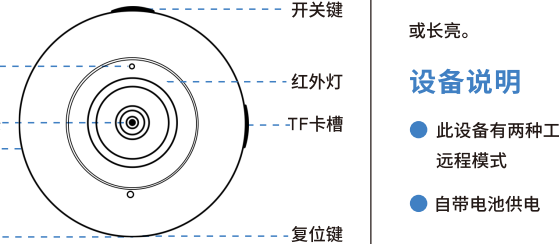

## 使用手册

### 外观介绍



— 1 —

### 恢复出厂方法

摄像机开机状态, 按住复位键3秒左右直到看到红灯和蓝灯交替慢闪, 随后蓝灯慢闪或长亮。

### 设备说明

- 此设备有两种工作模式: AP热点模式和WiFi远程模式
- 自带电池供电
- 可插入DC5V/2A电源

— 2 —

### 指示灯状态

**黄灯**: 充电中长亮, 充满电熄灭。

**蓝灯**: AP模式。慢闪录像中, 长亮停止录像。

**红灯**: 远程模式。慢闪录像中, 长亮停止录像, 快闪

WiFi连接中。

**恢复出厂**: 蓝灯和红灯交替慢闪。

**低电报警**: 蓝灯和红灯同时快闪。

— 3 —

### 第一步 安装前准备

☒ 开关键按一下开机

☒ 复位键长按3秒恢复出厂设置。

☒ 第一次连网使用建议将摄像机放置于路由器2米之内

☒ 手机连接路由器Wi-Fi, 并清楚Wi-Fi连接密码。

(只支持2.4GHz Wi-Fi)  
(关机操作: 长按开关键3秒关机)

— 4 —

### 第二步 APP下载和注册



① 请在手机商城搜索“Fowl”下载APP, 或者扫描二维码下载。

— 5 —

### 第三步 添加设备到APP

#### 方法一: 声波连接

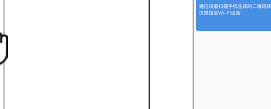

① 点击添加设备, 选择WiFi摄像机。



② 请输入正确的WiFi密码。(设备目前不支持5G Hz网络。)

— 7 —

#### 方法二: AP连接



③ 大约20秒左右, 会提示绑定成功。



④ 点击“立即绑定”。

— 8 —

#### 方法二: AP连接



① 请进入手机设置—选择OK-XXX开头的WiFi热点并连接。



② 打开APP, 点击播放即可观看和操作摄像机。

— 9 —

### 配置WiFi



① 进入摄像机参数设置。



② 选择WiFi配置。

— 10 —

### 设备分享



③ 选择您的无线网络并正确输入WiFi密码。



④ 分享图片。

— 11 —

### 进入摄像机“参数设置”, 点开“设备分享”, 选择“二维码分享”。

其他用户可打开APP, 点击首页右上角“+”符号, 扫描此二维码添加设备。



— 12 —



# USER MANUAL

## Product Description

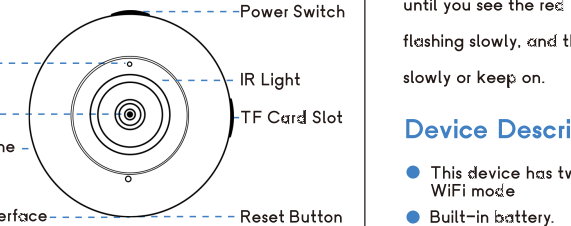

— 1 —

## How to factory reset:

When the camera is turned on, hold on the reset button for about 3 seconds until you see the red light and blue light alternately flashing slowly, and then the blue light flashing slowly or keep on.

## Device Description

- This device has two modes: AP mode and WiFi mode
- Built-in battery.
- Support DC5V/2A power supply.

— 2 —

## Indicator Status

**Yellow light:** always bright during charging, goes off when fully charged.

**Blue light:** AP mode, slow flash---recording, always bright---stop recording.

**Red light:** WiFi mode, slow flash---recording, always bright---stop recording, fast flash---during WiFi connection.

**Factory reset:** the blue light and red light flash alternately slowly.

**Low battery alarm:** the blue light and red light flash rapidly at the same time.

— 3 —

## Step 1: Pre-Setup

- ✓ Press power to turn on the camera.
  - ✓ Long press the reset button 3 seconds to factory reset.
  - ✓ It's recommended to place the camera within 2 meters of the router for the first time connecting to the Internet.
  - ✓ Connect the mobile phone to the router Wi-Fi, and know the Wi-Fi connection password. (Only 2.4GHz Wi-Fi is supported)
- (How to power off: Long press the power button for 3 seconds to power off)

— 4 —

## Step 2 : APP Download and Registration

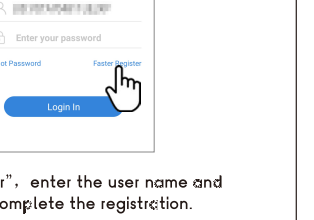

- 1 Search for "Fowl" in App Store or Google Play, or scan the QR code to download the app.

— 5 —

## Method One: Sonic Connection

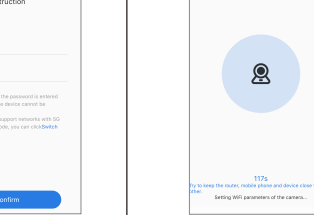

- 1 Click Add device and choose WiFi camera.

— 6 —

## Method Two: AP Connection

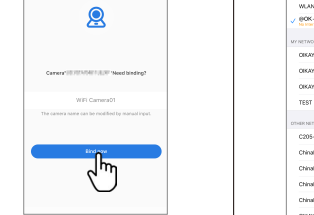

- 2 Please enter the correct WiFi password, (The device does not support 5G Hz network).

— 7 —

## Step 3: Add Devices to the APP

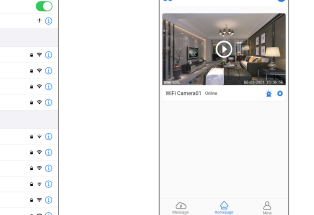

- 3 About 20 seconds later, you will be prompted for a successful binding.

— 8 —

## Method One: Sonic Connection

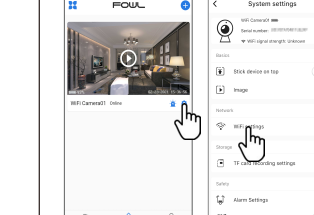

- 4 Click "Bind now".

— 9 —

## Method Two: AP Connection

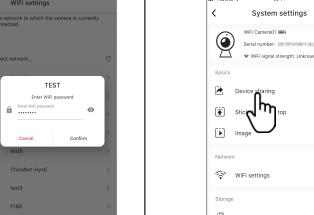

- 1 Please go to your mobile phone Settings, select the WiFi hotspot that start with OK-XXX and connect it.

— 10 —

## Method One: Sonic Connection

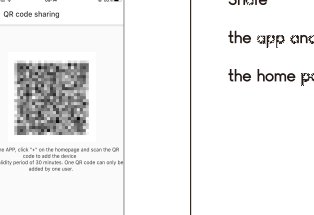

- 2 Open the app and click play to watch and operate the camera.

— 11 —

## Method Two: AP Connection

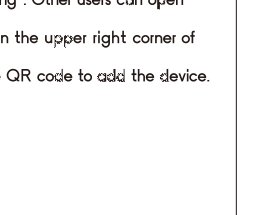

- 3 Select your home WiFi and enter the WiFi password correctly.

— 12 —