

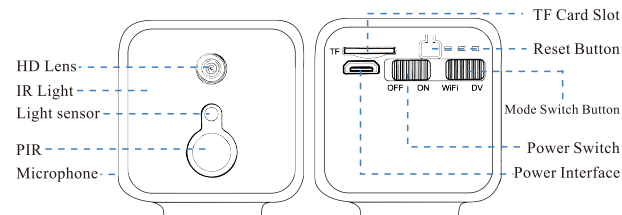

# USER MANUAL

## Product Description



**How to reset camera:** Turn the power switch to "ON", hold on the reset button for 5 seconds until you see the blue light and the green light turn on together, and then the blue light flashes slowly.

## Device Description

- This device has two modes: IP Camera (WiFi) mode and Recorder (DV) mode.
- Built-in battery.
- Support DC5V/2A power supply.

## Indicator Status

**Yellow light:** always bright during charging

**Blue light:** slow flash---waiting for connection; fast flash---during connection; always bright ---connection success

**Green light:** slow flash---during recording; fast flash---does not insert a TF card

**Restore factory:** the green and blue lights are on, then the blue light flashes slowly

## Step 1: Pre-Setup

- ☑ Turn the power switch to "ON" mode.
- ☑ Turn the mode switch button to "WiFi" mode.
- ☑ It is recommended to place the camera within 2 meters of the router.
- ☑ Connecting the phone to the WiFi and make sure know the exact WiFi password (only supports 2.4GHz).

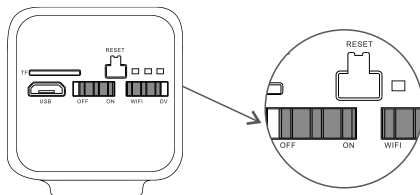

## Step 2 : APP Download and Registration



- 1 Search for "Fowl!" in App Store or Google Play, or scan the QR code to download the app.

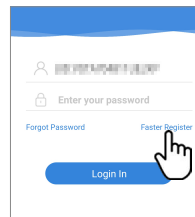

- 2 Click "Register", enter the user name and password to complete the registration.

## Step 3: Add Devices to the APP

### Method One:

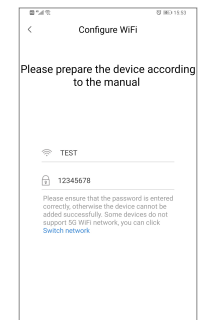

- 1 Click Add device and choose WiFi camera.
- 2 Please enter the correct WiFi password, (The device does not support 5G Hz network).

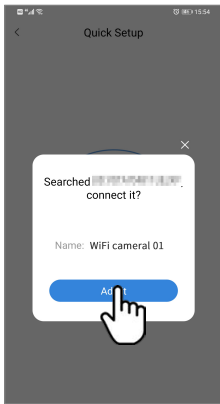
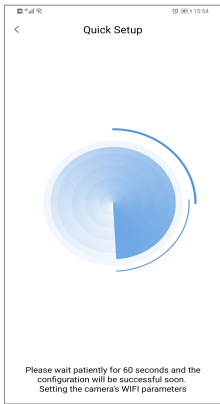

- 3 About 20 seconds later, you will be prompted for a successful binding.
- 4 Click “Add it”.

### Method Two:

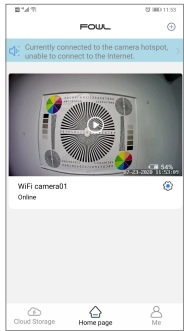
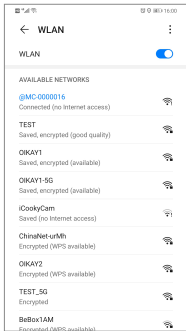

- 1 Please go to your mobile phone WiFi Settings , select the WiFi hotspot that start with MC-XXX and connect it.
- 2 Open the app and Click play to watch and operate the camera.

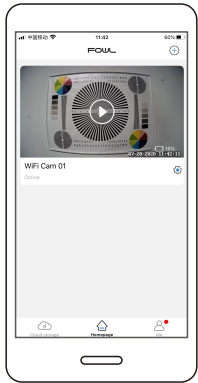

### You are Done!

To enhance the security, the initial password need to be changed.

Please write down your device information:

Fowl account name: \_\_\_\_\_

Fowl account password: \_\_\_\_\_

### Configure WiFi

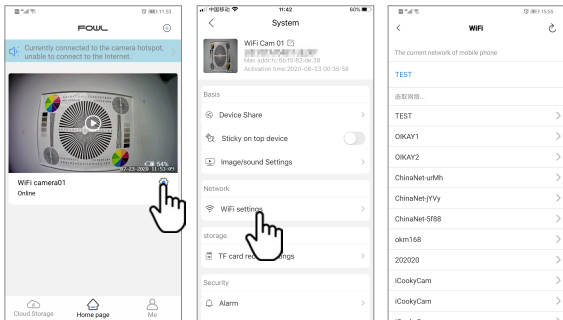

- 1 Enter camera parameters
- 2 Select WiFi settings.
- 3 Select your home WiFi and enter the WiFi password correctly.

### DV Mode Usage

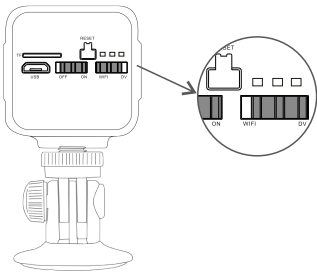

Turn the power switch to "ON", the mode switch button to "DV", and insert a TF card for 24 hours of continuous recording.

How to view recording videos?

- 1 Turn the mode switch button to WiFi mode, enter the APP, and go to "TF card" to view.
- 2 Place the TF card in the card reader and plug the card reader to the computer, then you can view the video on the computer.

### Device Share

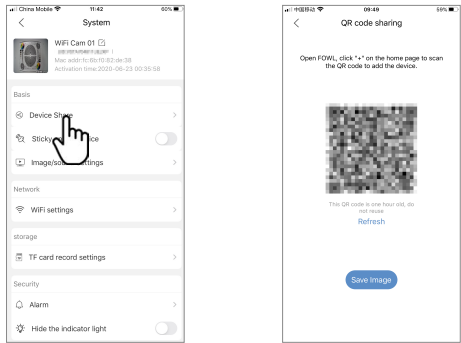

Click "Settings" on the right corner, then select "Device Share" --- "QR Code Sharing". Other users can open the app and click the "+" in the upper right corner of the home page to scan the QR code to add the device.